

Q clamp



Structural Flush Side Palm Fixing

Product number

146

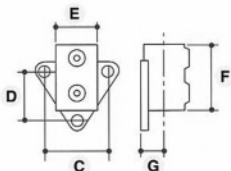

Q CLAMP REF No.	A	B	C	D	E	F	G	HOLE DIA mm	WEIGHT kgs
146-2	2		78	68	45	70	25	12	0.63
146-3	3		86	75	56	79	28	12	0.81
146-4	4		96	83	61	86	32	12	0.96

Structural flush side palm base fixing guardrailing to wall, steps or ramps etc. The flush design enables posts to be tight to the structure. The tube is unable to pass through the fitting. Should this be required then the base must be reamed out. If the base is reamed out the bottom fixing will become redundant.